

# Coaxial Adapter

**Part No.: WLD-1212**



## 18GHz SMA Female to SMA Female Coaxial Adapter

### Features

- High Stability
- Low Return Loss



Specification	
Frequency :	18GHz
VSWR:	1.3: 1 (MAX.)
Impedance:	50Ω
Connector Type:	SMA Female to SMA Female

No	Description	Material	Q'ty	Finish
01	Body	Brass	1	Gold
02	Insulator	Teflon	2	
03	Center Pin	Phosphor Bronze	1	Gold

### Outline Drawing

Units: mm

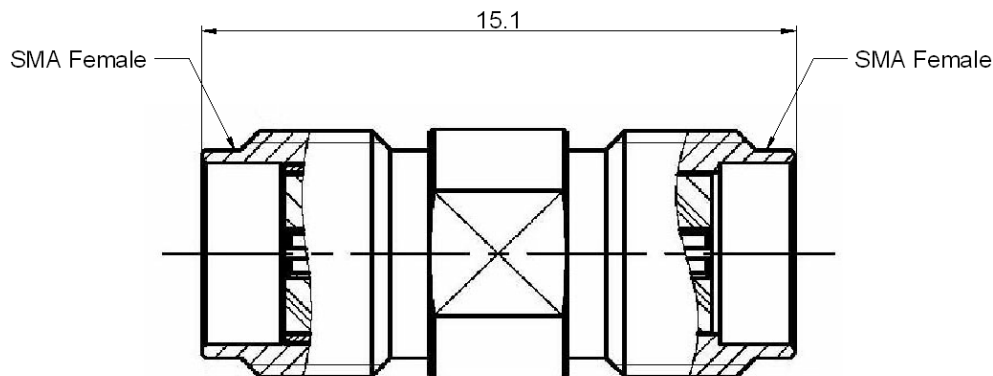

**Dimension Tolerance: ±0.5 mm**